

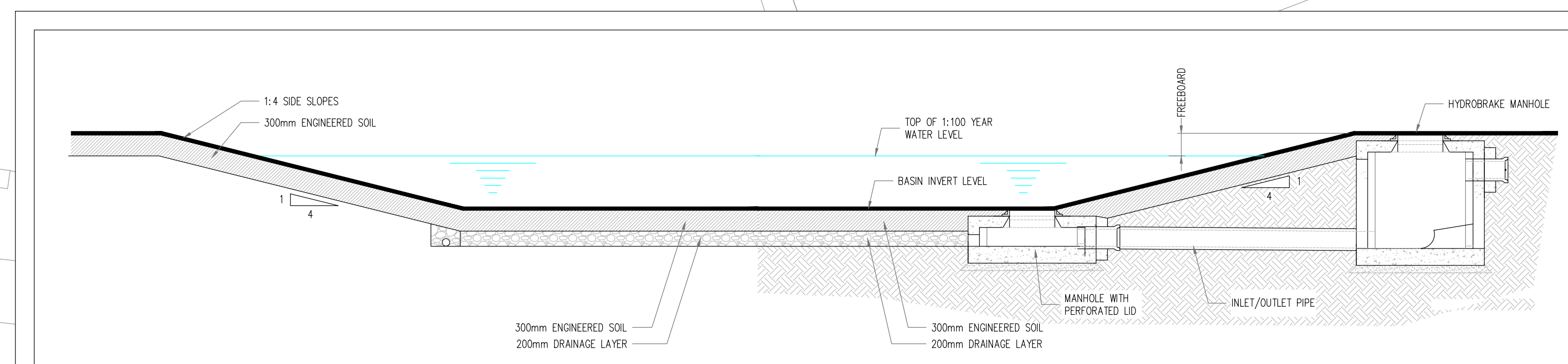

- NOTES:**
- CONTRACTOR TO CONFIRM EXISTING LEVELS AT SEWER TE INS MATCH THAT OF EXISTING LEVELS SHOWN ON DRAWING PRIOR TO COMMENCEMENT OF WORKS.
 - THE COVER LEVELS INDICATED ARE APPROXIMATE.
 - ALL WORKS IN CONFINED SPACES SHALL BE CARRIED OUT IN STRICT ACCORDANCE WITH THE PROVISIONS ON "SAFE WORK" IN CONFINED SPACES" CODE OF PRACTICE FOR WORKING IN CONFINED SPACES, PUBLISHED BY THE HEALTH & SAFETY AUTHORITY.
 - ALL SITE DEVELOPMENT WORKS SHALL BE CARRIED OUT IN STRICT ACCORDANCE WITH THE CONSTRUCTION DRAWINGS.
 - ALL DRAINAGE WORKS SHALL BE CARRIED OUT IN STRICT ACCORDANCE WITH THE REQUIREMENTS OF THE LOCAL AUTHORITY, IN PUBLICATIONS SERIES 500 AND IRISH WATER CODE OF PRACTICE FOR WASTEWATER.
 - THIS DRAWING SHOULD BE READ IN CONJUNCTION WITH ALL OTHER CONTRACT DOCUMENTATION, INCLUDING DRAWINGS AND SPECIFICATIONS.
 - THE CONTRACTOR IS SOLELY RESPONSIBLE FOR LOCATING, PROTECTING AND MAINTAINING ALL EXISTING SERVICES WITHIN THE SITE BOUNDARY AND IN THE AREAS AFFECTED BY THE WORKS. THE ENGINEER HAS PROVIDED INFORMATION ON KNOWN SERVICES BUT DOES NOT GUARANTEE THAT THIS INFORMATION PROVIDED BY THE THIRD PARTIES IS CORRECT OR THAT THESE ARE THE ONLY SERVICES ON THE SITE.
 - SUITABLE SHORT LENGTHS OF PIPE OR RODDER PIPES SHALL BE INSTALLED TO PROVIDE A FLEXIBLE JOINT WITHIN 1000mm OF THE OUTER FACE OF THE MANHOLE ON ALL SEWERS AND BRANCHES.
 - WHERE ROCK IS MET IN TRENCHES IT SHALL BE EXCAVATED AND TRIMMED TO 300mm BELOW THE UNDERSIDE OF PIPELINE.
 - GRANULAR MATERIAL 5mm - 20mm NOMINAL SIZE GRADED AGGREGATE (TO COMPLY WITH TABLE 1 OF BS) TO BE USED FOR BEDDING, HAUNCHING AND SURROUND TO PIPES WHERE SPECIFIED.
 - CONCRETE MIX C16/20 TO BE USED FOR BEDDING, HAUNCHING AND SURROUND WHERE SPECIFIED.
 - WHERE ROD PIPES WITH FLEXIBLE JOINTS ARE USED WITH CONCRETE BEDS FOR DRAINS AND WATERMANS, VERTICAL MOVEMENT JOINTS SHALL BE PROVIDED IN THE BEDS AT MAX INTERVALS OF 5.0m AND ALIGNED WITH FACE OF PIPE SOCKET. JOINTS TO BE MINIMUM 12m WIDE AND FILLED WITH FLEXCELL OR SIMILAR APPROVED MATERIAL.
 - SURFACE WATER AND FOUL DRAINS SHALL BE SURROUNDED BY 150 THICKNESS OF C16/20 CONCRETE IF COVER TO PIPE IS LESS THAN -1.2m IN ROADS AND DRIVEWAYS, -0.9m IN OPEN SPACES AND PATHS NOT NEAR CARRIAGEWAYS.
 - ALL PIPE RUNS SHALL BE LAID IN STRAIGHT LINES BOTH VERTICALLY AND HORIZONTALLY TO THE SPECIFIED GRADIENTS BETWEEN MANHOLES. NO DEVIATIONS OR BENDS SHALL BE PERMITTED.
 - FOR ALL MANHOLE DETAILS, PIPE BEDDING, SURROUND AND HAUNCHING DETAILS AS PER DWG A034-CSC-ZZ-XX-DR-C-0009. MANHOLE COVERS & FRAMES, ROAD GULLIES, TESTING & CLEANING OF DRAINS AND SEWER DIVERSIONS, REFER TO THE CIVIL WORKS SPECIFICATION AND IRISH WATER CODE OF PRACTICE.
 - VERTICAL BACKDROP IN MANHOLES SHALL BE IN ACCORDANCE WITH IR STD-WR-12 OF IRISH WATER WASTEWATER STANDARD DETAILS.
 - REFER TO DRAWING NUMBER A034-CSC-ZZ-XX-DR-C-0011 FOR DETAILS OF PROPOSED PETROL INTERCEPTORS. NOTE KLARGESTER INTERCEPTORS HAVE BEEN SPECIFIED IN THE DESIGN. CONTRACTOR MAY PROPOSE EQUIVALENT PRODUCTS WHICH COMPLY WITH THE PERFORMANCE SPECIFICATION OF THE MODELS SPECIFIED.
 - THE CONTRACTOR SHALL CARRY OUT A CCTV SURVEY REPORT OF THE COMPLETED STORM & FOUL NETWORK TO THE SATISFACTION OF THE LOCAL AUTHORITY AND REPORT TO BE ISSUED ON PRACTICAL COMPLETION.
 - VENTILATION STACKS TO BE PROVIDED FOR ALL PETROL INTERCEPTORS (MIN HEIGHT 3m ABOVE GROUND LEVEL) WHERE VENTILATION STACKS CANNOT BE FIXED TO BUILDING OR FENCES FREE STANDING STACK BY SFP OR EQUIVALENT SHALL BE PROVIDED.
 - TESTING AND DISINFECTION SHALL COMPLY WITH SECTION 7 OF THE IRISH WATER GENERAL CIVIL ENGINEERING SPECIFICATION (DOC NO. IW-TEC-300-01).
 - THE LOCAL AUTHORITY MUST BE NOTIFIED AT LEAST TO WORKING DAYS IN ADVANCE OF COMMENCEMENT OF WORKS.

PIPE MATERIALS
 100mm to 300mm PIPES TO BE uPVC TO S18
 375mm to 900mm PIPES TO BE PRECAST CONCRETE (SEN1916/2002)

PROPOSED SUDS LAYOUT
 SCALE: 1:500



TYPICAL SECTION THROUGH DETENTION BASIN
 SCALE 1:50



INDICATIVE DETENTION BASIN

PLANNING DRAWING.
NOT FOR CONSTRUCTION.
 ALL LEVELS GIVEN ARE
 RELATIVE TO ORDNANCE DATUM.
 THIS DRAWING HAS BEEN ISSUED FOR INFORMATION
 PURPOSES ONLY AND MUST NOT BE USED
 FOR CONSTRUCTION UNDER ANY CIRCUMSTANCES

- NOTES**
- For setting out refer to Architect's drawings.
 - This drawing to be read in conjunction with all other Architectural and Engineering drawings and all other relevant drawings and Specifications.
 - DO NOT SCALE THIS DRAWING. Use figure dimensions only.
 - No part of this document may be reproduced or transmitted in any form or stored in any retrieval system of any nature without the written permission of copyright holder except as agreed for use on the project for which the document was originally issued.
 - Ordnance Survey Ireland Licence Number EN 0074023

| Rev. No. | Date | REVISION NOTE | Drn. By | Chk. By |
|----------|------------|-------------------------|---------|---------|
| P1 | 13.12.2022 | ISSUED FOR PLANNING | SC | NB |
| P2 | 16.04.2023 | ISSUED FOR COORDINATION | SC | NB |
| P3 | 07.07.2023 | ISSUED FOR COORDINATION | SC | NB |
| P4 | 09.08.2023 | ISSUED FOR PLANNING | SC | NB |

| | |
|---------------|---|
| Client | Keldrum Limited |
| Project | Large-scale Residential Development at Trillicky, Wicklow |
| Title | Proposed SUDS Layout Sheet 1 of 2 |
| Dep. No. | A034-CSC-ZZ-XX-DR-C-0037 |
| Date | 02 Oct 2022 |
| Unity | SC NB OS |
| Apprty. Scale | 1:500 @ A0 |
| Revision | P4 |

CS Consulting Group
 DUBLIN | LONDON | LIMERICK
 Head Office
 19-21 Dame Street, Dublin 2.
 T: +353 (0) 1 454 0863
 E: info@csconsulting.ie
 W: www.csconsulting.ie

Quality ISO 9001:2015
 Environment ISO 14001:2015
 Health & Safety OHSAS 18001:2007

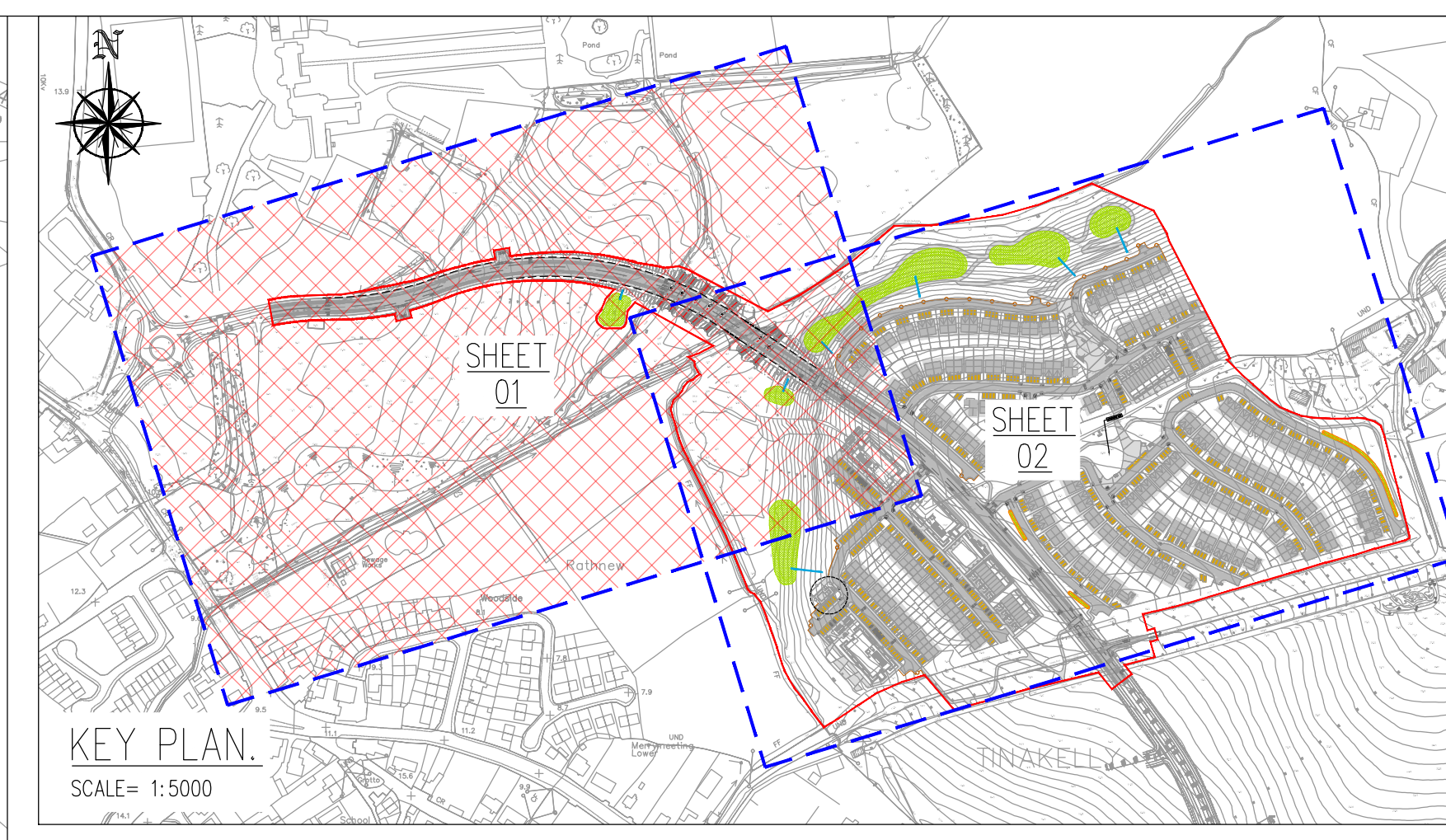

LEGEND:

| | |
|------------------------------|---|
| SITE BOUNDARY | — |
| PROPOSED PERMEABLE PARKING | ▨ |
| PROPOSED SURFACE WATER SEWER | — |
| PROPOSED SURFACE WATER MAIN | — |
| SURFACE WATER STORAGE BASIN | ▨ |
| PROPOSED HEADWALL | — |